

623 signal male straight metal plug connector

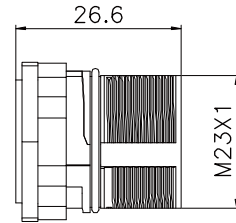
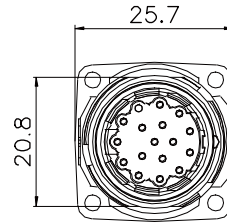

Technical parameters

Shell material	Copper/Zinc
Core material	PBT/PA66
Overmold material	PVC/TPU [®]
Terminal material	Phosphor copper
Temperature	-40°C~+125°C

Insulation resistance	≥100mΩ
Contact resistance	≤5mΩ
Degree of protection	IP67
Mating cycle	≥500次
Cable diameter	

Electric parameter

M 2 3

pin number	code type A	rated current	rated voltage		cable size		cable material	dealing at the end cable
			A/C	D/C	AWG	mm ²		
6		20A	300V	300V	14	2.5	PVC/PUR	- no dealing - customized - strip and tinn - to other connector
7		20A	300V	300V	14	2.5	PVC/PUR	
9		8A	150V	150V	18	1	PVC/PUR	
9P(8+1)		8A/20A	300V	150V	18/14	1/2.5	PVC/PUR	
12		8A	150V	150V	18	1	PVC/PUR	
17		8A	150V	150V	18	1	PVC/PUR	
19P(16+3)		8A/10A	150V	150V	18/16	1/1.5	PVC/PUR	

Order method

<p>Ⓐ Regular type</p> <p>623G-<input type="text"/>-H-<input type="text"/>-P-<input type="text"/>-<input type="text"/>-<input type="text"/>-<input type="text"/></p> <p style="text-align: center;"> code type (except A type) cable material others </p> <p style="text-align: center;"> pin number overmold material cable length </p>	<p>Ⓑ Customized</p> <p>623G-<input type="text"/>-H-<input type="text"/>-P-<input type="text"/>-<input type="text"/></p> <p style="text-align: center;"> code type (except A type) others </p> <p style="text-align: center;"> pin number customized item number </p>
---	--